

Quick Start Guide

Coda W

Wireless Hi-Fi Speaker

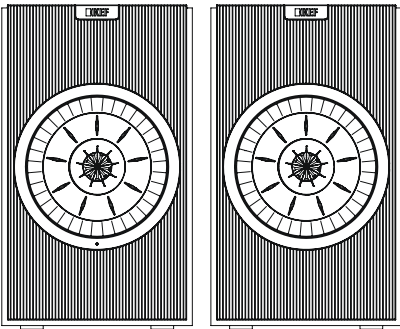

Coda W



English	1
Deutsch	17
Français	33
Español	49
日本語	65
简体中文	81
繁體中文	97
한국어	113

In the Box

Check whether Coda W or any parts are damaged or missed. If this is the case, do not use the product and contact your retailer.

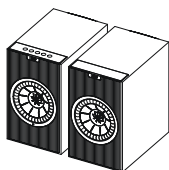

Coda W

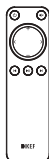

Remote control



Interspeaker cable x1



Power cable x1



AAA batteries



Printer materials

Product Overview

Primary and Secondary Speakers

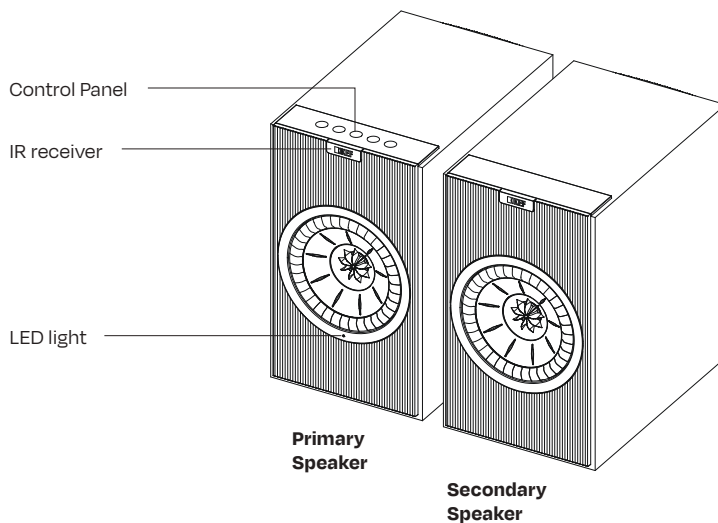

Control Panel

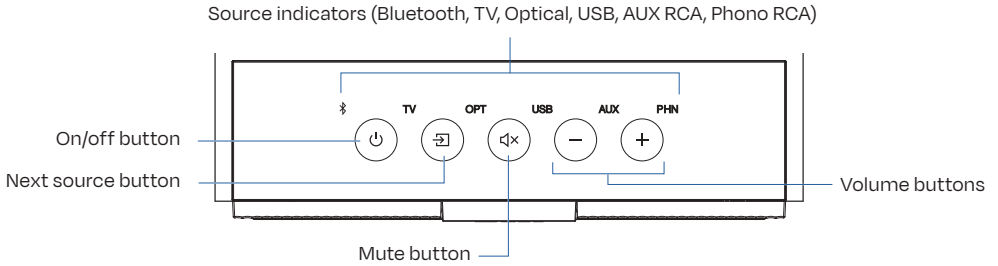

Remote Control

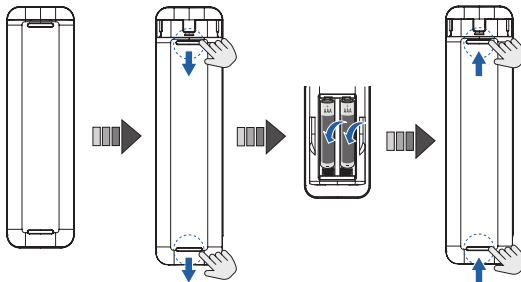
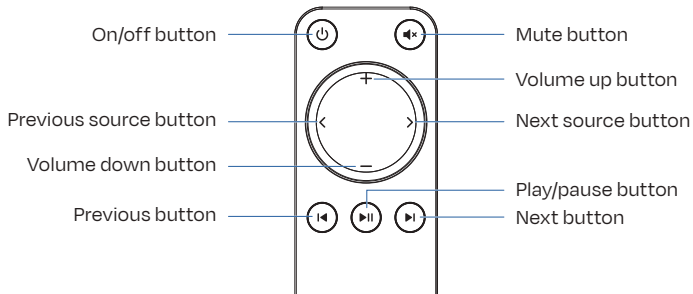

Press on the circled areas to slide open or close the battery compartment cover. Battery life varies based on storage time and usage. Replace with new AAA alkaline batteries if you notice inconsistent performance.

Back Panel

Primary Speaker (Right channel)

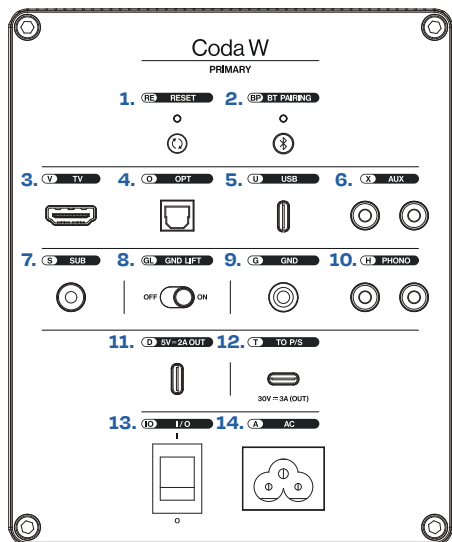

Secondary Speaker (Left channel)

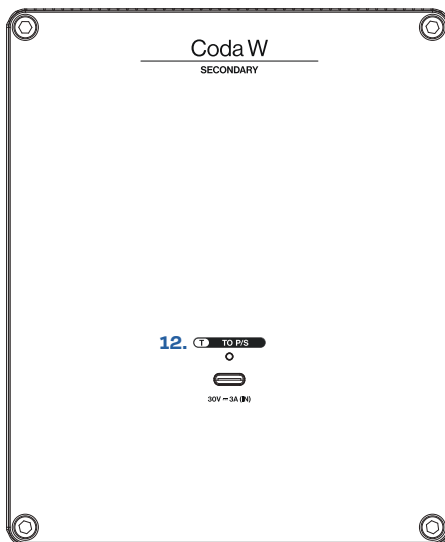

1.	RE RESET	Reset button
2.	BP BT PAIRING	Bluetooth pairing button
3.	V TV	HDMI (ARC) input
4.	O OPT	Optical input
5.	U USB	USB input
6.	X AUX	RCA AUX input
7.	S SUB	Subwoofer output
8.	GL GND LIFT	System ground lift
9.	G GND	Phono ground
10.	H PHONO	RCA phono input
11.	D 5V-2A OUT	Charging output
12.	T TO P/S	Connection ports for Primary and Secondary Speakers
13.	IO I/O	Power switch
14.	A AC	AC power input

Setting up Coda W

1. Placement

For the best performance:

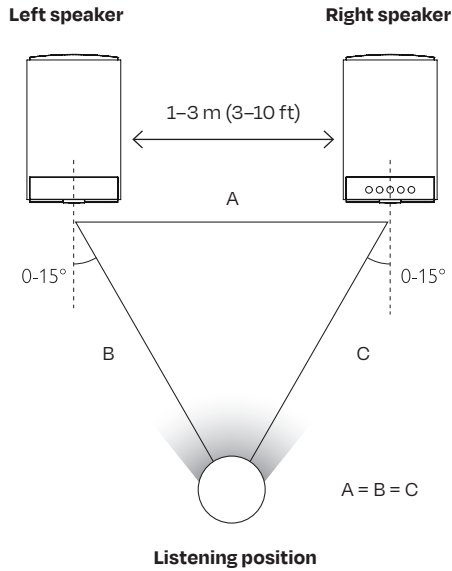

2. Connecting to Power and Switching On

1. Connect the Primary Speaker to the Secondary Speaker with the interspeaker cable via the connection ports (T).
2. Insert the power cable into the AC power input (A) of the Primary Speaker and connect the cable to a power socket.

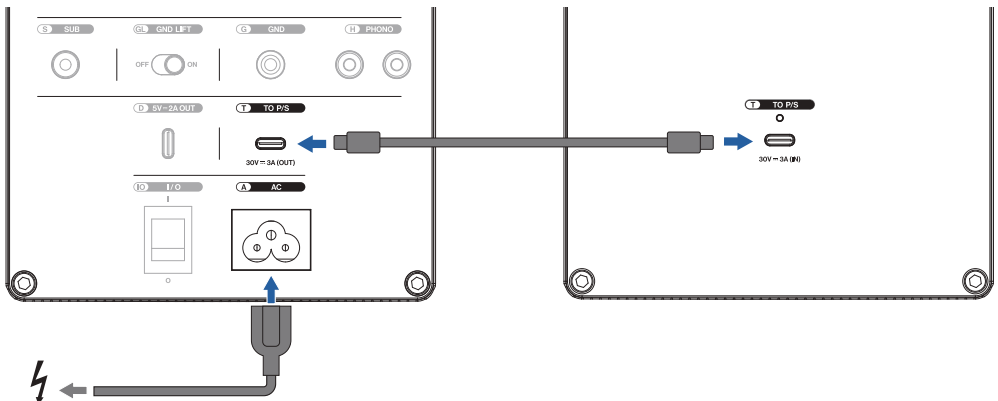

3. Set the power switch (IO) to the "I" (ON) position on the Primary Speaker.

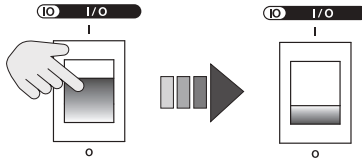

The power button illuminates, indicating that Coda W is powered on in the Standby mode and ready for use. Tap on the power button to wake Coda W from the Standby mode.

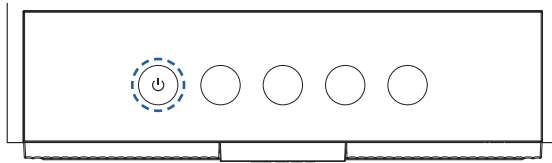

3. Installing KEF Connect App

- Download and install "KEF Connect" on your iOS* or Android** device to personalise your experience and access the latest features, improvements and security updates.



*Requires iOS 14 or above. Refer to App Store for the latest requirements (subject to change).

**Requires Android 10 or above. Refer to Google Play for the latest requirements (subject to change).

Playback with Bluetooth

1. Power on Coda W and switch to the Bluetooth mode through the control panel, remote control or KEF Connect App.

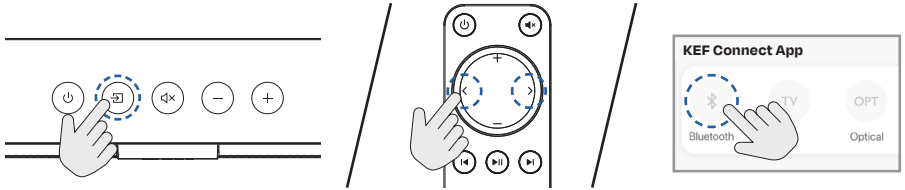

The LED light on the front of the Primary Speaker illuminates **blue** when the Bluetooth mode is selected. The Bluetooth icon on the control panel should pulse white, indicating that Coda W is in the discovery mode and ready to pair with a Bluetooth device.

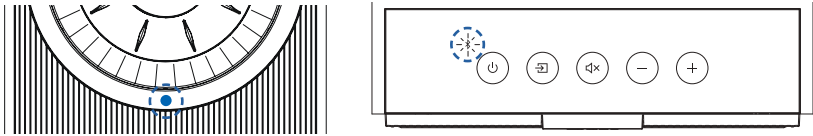

2. Turn on the Bluetooth feature of your device and select "KEF Coda W" from the list of available devices to pair.

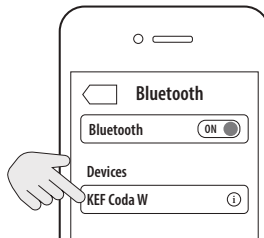

When pairing is successful, the Bluetooth icon on the control panel illuminates white continuously.

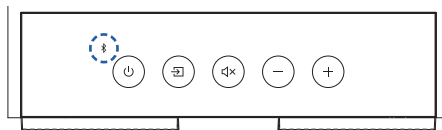

3. Play content on your device and enjoy the experience with Coda W.

Playback from TV with HDMI (ARC) Input

1. Connect your TV's (e)ARC port to the HDMI (ARC) input (v) of Coda W with an HDMI cable.

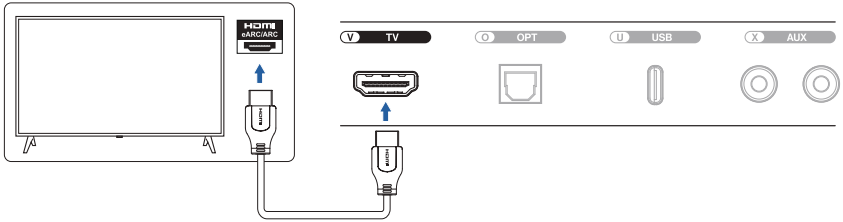

2. Power on Coda W and switch to the TV mode through the control panel, remote control or KEF Connect App.

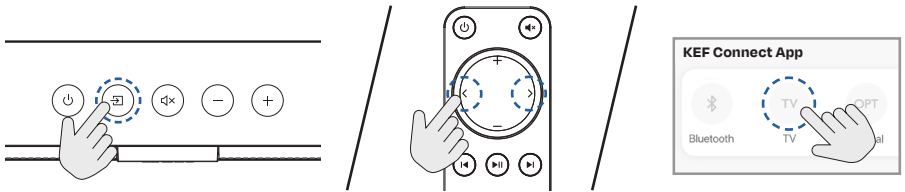

The LED light on the front of the Primary Speaker illuminates **cyan** when the TV mode is selected. The TV icon on the control panel illuminates white continuously when the TV connection is successfully made.

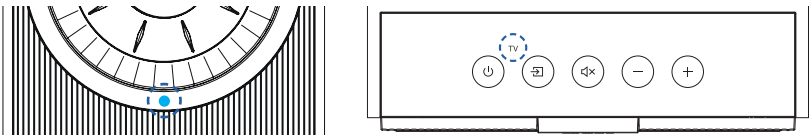

3. Play content on your TV and enjoy the experience with Coda W.
- Set your TV's digital audio output to "PCM" as Coda W only supports PCM output.

Playback with Optical Input

1. Connect your optical device to the Optical input (O) of Coda W with an optical cable.

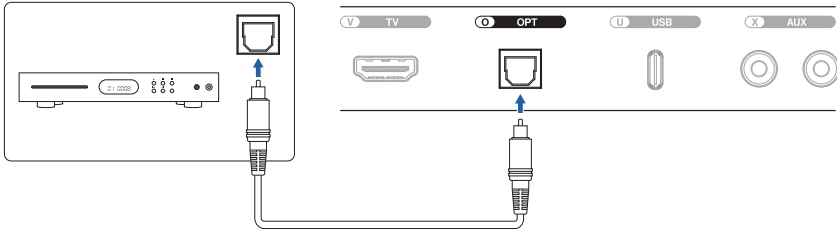

2. Power on Coda W and switch to the Optical mode through the control panel, remote control or KEF Connect App.

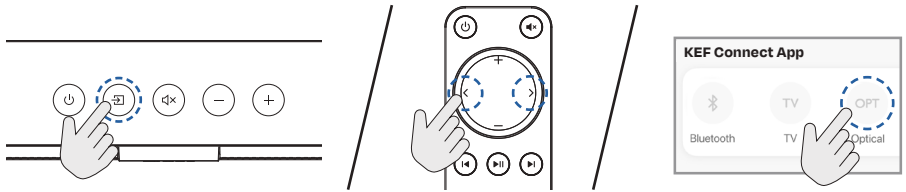

When the Optical mode is selected, the LED light on the front of the Primary Speaker illuminates **magenta** and the OPT icon on the control panel illuminates white continuously.

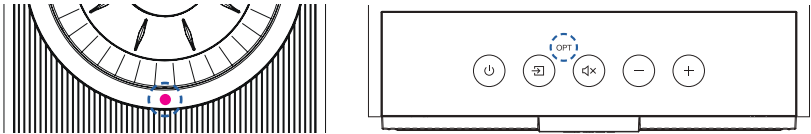

3. Play content on your optical device and enjoy the experience with Coda W.

Playback from USB Audio Device

1. Connect your USB device to the USB input (**U**) of Coda W with a USB-C cable. Make sure the USB-C cable supports data transfer.

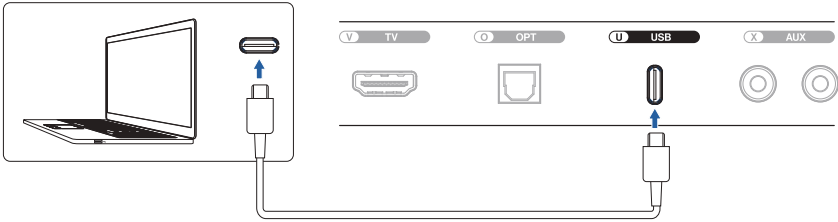

2. Power on Coda W and switch to the USB mode through the control panel, remote control or KEF Connect App.

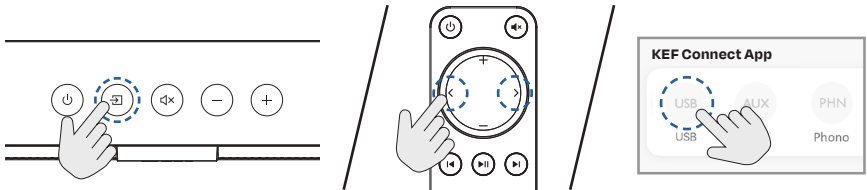

When the USB mode is selected, the LED light on the front of the Primary Speaker illuminates **pink** and the USB icon on the control panel illuminates white continuously.

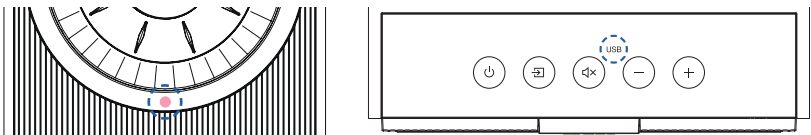

3. From your USB device, select "KEF Coda W" as the output device and enjoy the experience with Coda W.

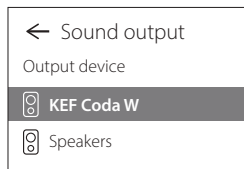

Playback with AUX Input

1. Connect your auxiliary device to the RCA AUX input (**X**) of Coda W with an RCA cable.

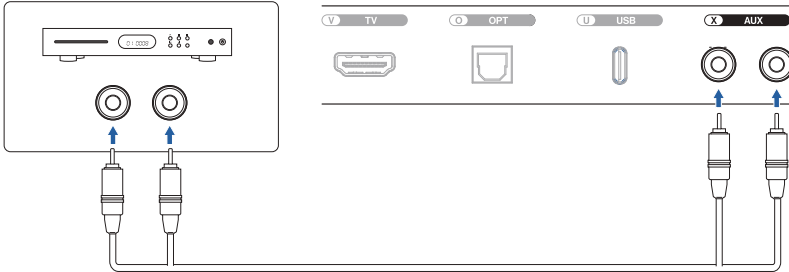

2. Power on Coda W and switch to the AUX mode through the control panel, remote control or KEF Connect App.

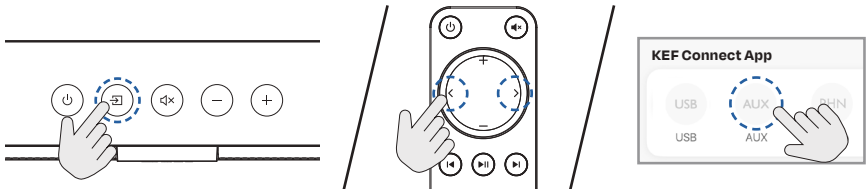

When the AUX mode is selected, the LED light on the front of the Primary Speaker illuminates **yellow** and the AUX icon on the control panel illuminates white continuously.

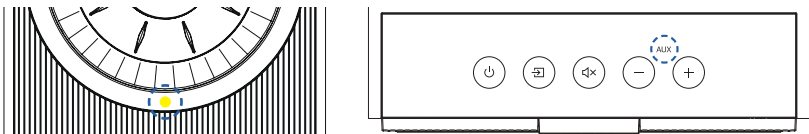

3. Play content on your auxiliary device and enjoy the experience with Coda W.

Playback from Turntable

1. Connect your turntable to the RCA phono input (**H**) of Coda W with an RCA cable.

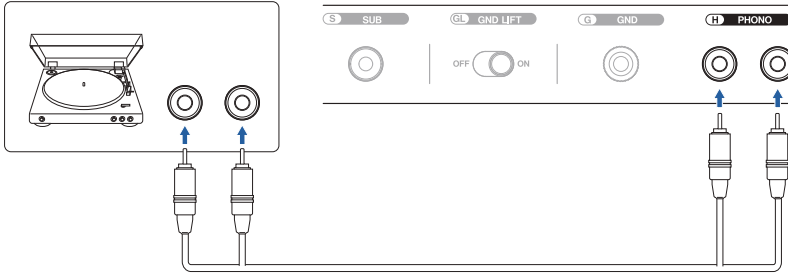

2. Attach the ground wire of the turntable to the phono ground (**G**) of Coda W by loosening the screw at the phono ground, placing the wire beneath it, and tightening the screw again.

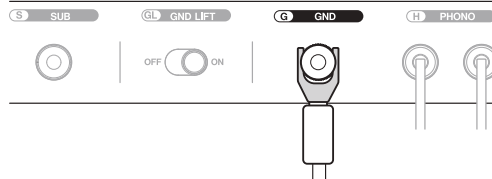

3. Power on Coda W and switch to the Phono mode through the control panel, remote control or KEF Connect App.

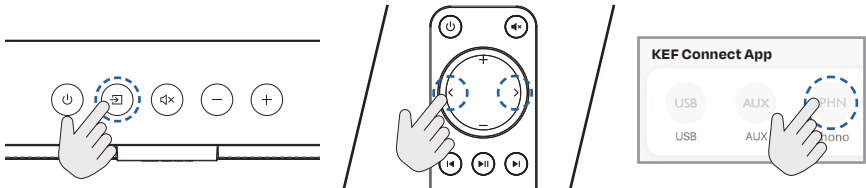

When the Phono mode is selected, the LED light on the front of the Primary Speaker illuminates **light purple** and the PHN icon on the control panel illuminates white continuously.

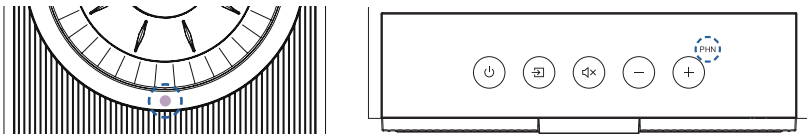





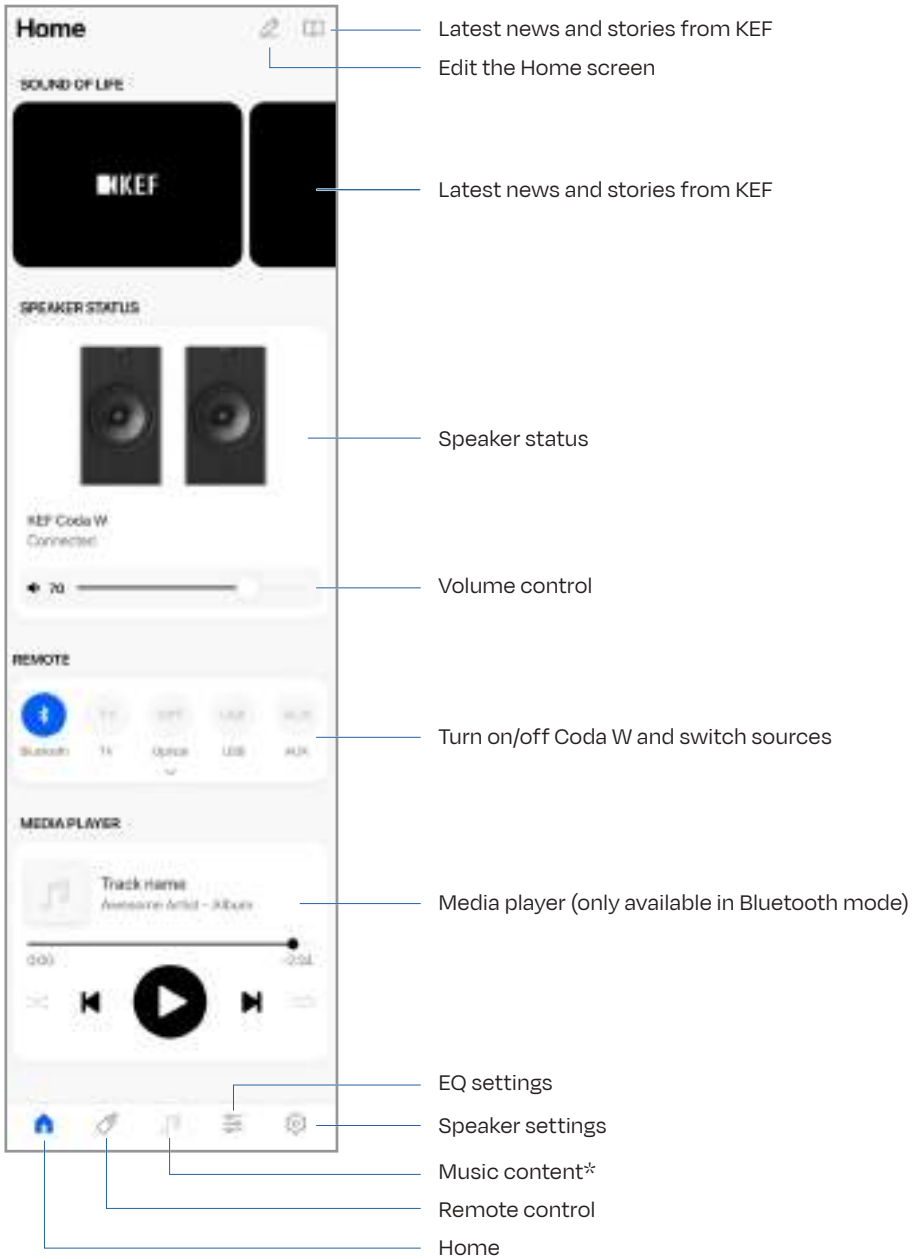





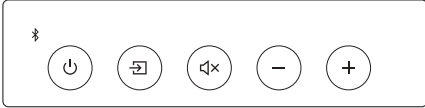

4. Play content on your turntable and enjoy the experience with Coda W.







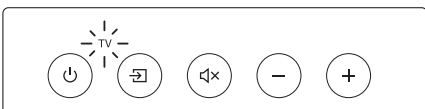

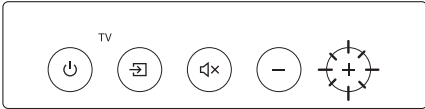

KEF Connect App Overview

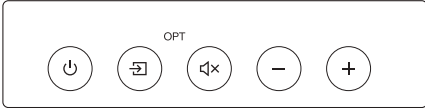

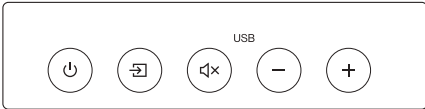
*Not available for Coda W (Only available for KEF Wi-Fi speakers)

Basic LED Indications

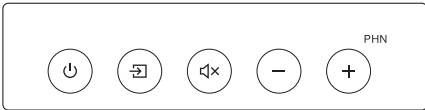
Control panel	LED light (Front of Primary Speaker)	Status
	 Solid amber	Coda W is in Standby mode.
On/off button illuminates.		
	 Solid blue	Coda W is in Bluetooth mode and already connected to a Bluetooth device.
Bluetooth icon is solid.		
	 Pulsing blue	Coda W is in Bluetooth mode and ready to pair with a Bluetooth device.
Bluetooth icon is pulsing.		
	 Solid cyan	Coda W is in TV mode and successfully connected to a TV.
TV icon is solid.		
	 Pulsing cyan	Coda W is in TV mode and trying to establish an audio connection. If the problem persists, please change the HDMI cable.
TV icon is pulsing.		
	 Blinking cyan quickly	Coda W is in TV mode but fails to establish a TV connection. Make sure that the HDMI cable is correctly connected between Coda W and the TV.
TV icon is blinking quickly.		

Control panel	LED light (Front of Primary Speaker)	Status
<div data-bbox="76 143 501 252">  </div> <p data-bbox="67 268 476 319">TV icon is solid and Volume Up button is blinking.</p>	<div data-bbox="565 175 744 279">  <p data-bbox="565 223 744 279">Blinking cyan and magenta</p> </div>	<p data-bbox="784 135 1036 319">Coda W is in TV mode and has successfully connected to the TV. However, the received audio signal is non-PCM. Please change your TV settings to PCM output.</p>
<div data-bbox="76 343 501 451">  </div> <p data-bbox="67 470 240 502">OPT icon is solid.</p>	<div data-bbox="576 383 728 462">  <p data-bbox="576 430 728 462">Solid magenta</p> </div>	<p data-bbox="784 399 991 454">Coda W is in Optical mode.</p>
<div data-bbox="76 534 501 643">  </div> <p data-bbox="67 662 240 694">USB icon is solid.</p>	<div data-bbox="599 574 705 654">  <p data-bbox="599 622 705 654">Solid pink</p> </div>	<p data-bbox="784 598 1030 630">Coda W is in USB mode.</p>
<div data-bbox="76 726 501 834">  </div> <p data-bbox="67 853 240 885">AUX icon is solid.</p>	<div data-bbox="588 766 716 845">  <p data-bbox="588 813 716 845">Solid yellow</p> </div>	<p data-bbox="784 790 1030 821">Coda W is in AUX mode.</p>
<div data-bbox="76 917 501 1026">  </div> <p data-bbox="67 1045 240 1077">PHN icon is solid.</p>	<div data-bbox="565 957 739 1037">  <p data-bbox="565 1005 739 1037">Solid light purple</p> </div>	<p data-bbox="784 981 1047 1013">Coda W is in Phono mode.</p>