



M3 Soundbar

MANUAL

Contents

4	Important safety information and warnings
6	Introduction
6	Package contents
7	Feature summary
8	Product description
9	Wall mount
10	Features <ul style="list-style-type: none">Top panelFrontRear panel
15	Remote control
16	Operating Q Acoustics Unit <ul style="list-style-type: none">On / In / Wall EQPower and standbyIntelligent Pre-Amplifier (IPA™)Auto On / OffAuto On / Off TimesAuto source selectLow source gain (LSG™)Source volume controlPairing a Bluetooth® deviceMoviEQ™Lip Sync
20	Cable / satellite remote control
22	Specification
23	Warranty

Important Safety Information and Warnings

1 Notices

1.1 FCC Statement (For US Customers)

This device complies with Part 15 of the FCC Rules. Operation is subject to the following two conditions: (1) this device may not cause harmful interference, and (2) this device must accept any interference received, including interference that may cause undesired operation.

This equipment has been tested and found to comply with the limits for a Class B digital device, pursuant to part 15 of the FCC Rules. These limits are designed to provide reasonable protection against harmful interference in a residential installation. This equipment generates, uses and can radiate radio frequency energy and if not installed and used in accordance with the instruction manual, may cause harmful interference to radio communications. However, there is no guarantee that interference will not occur in a particular installation. If this equipment does cause harmful interference to radio or television reception, which can be determined by turning the equipment off and on, the user is encouraged to try to correct the interference by one or more of the following measures:

- Reorient or relocate the receiving antenna.
- Increase the separation between equipment and receiver.
- Connect the equipment into an outlet on a circuit different from that to which the receiver is connected.
- Consult the dealer or an experienced radio/TV technician for help.

1.2 FCC Radiation Exposure

This equipment complies with FCC radiation exposure limits set forth for an uncontrolled environment. This equipment should be installed and operated with a minimum distance of 8 in/20cm between the radiator and your body.

This transmitter must not be co-located or operated in conjunction with any other antenna or transmitter.

CAUTION! Any changes or modifications made to this device that are not expressly approved by Q Acoustics may void the user's authority to operate the equipment.

1.3 Industry Canada Statement (for Canadian Customers)

CAN ICES-3 (B)/NMB-3(B)

The device meets the exemption from the routine evaluation limits set out in section 2.5 of RSS 102 and is in full compliance with RSS-102 RF. Users can obtain information on RF exposure and compliance from Industry Canada.

This device complies with Industry Canada licence-exempt RSS standard(s). Operation is subject to the following two conditions:

- 1) This device may not cause harmful interference, and
- 2) This device must accept any interference received, including interference that may cause undesired operation.

1.4 Bluetooth®

This unit contains a Class 2 Bluetooth® transmitter working at 2.4GHz.

2 Safety Information and Warnings

2.1 Instructions

Read and understand these instructions before you use your Soundbar. If damage is caused by failure to follow these instructions, the warranty does not apply. Please keep these instructions in a safe place.

Read these instructions.

Keep these instructions.

Heed all warnings.

Follow all instructions.

Do not use this apparatus near water.

Clean only with dry cloth.

Do not block any ventilation openings. Install in accordance with the manufacturer's instructions.

Do not install near any heat sources such as radiators, heat registers, stoves, or other apparatus (including amplifiers that produce heat).

Protect the power cord from being walked on or pinched particularly at plugs, convenience receptacles, and the point where they exit from the apparatus.

Only use attachments/accessories specific by the manufacturer.

Use only with the cart, stand, tripod, bracket, or table specific by the manufacturer, or sold with the apparatus. When a cart is used, use caution when moving the cart/apparatus combination to avoid injury from tip-over.

Unplug this apparatus during lightning storms or when unused for long periods of time.

Refer all servicing to qualified service personnel. Servicing is required when the apparatus has been damaged in any way, such as power-supply cord or plug is damaged, liquid has been spilled or objects have fallen into the apparatus, the apparatus has been exposed to rain or moisture, does not operate normally, or has been dropped.

2.2 Installation

- The mains plug is the means of disconnecting the unit from the mains supply and shall be readily accessible.
- Only use the accessories supplied with the unit.

- To prevent injury, this apparatus must be securely attached to the floor/wall in accordance with the installation instructions.
- Never install this product in a confined space. Always leave a space or at least four inches around the product for ventilation.
- The ventilation should not be impeded by covering the ventilation openings with items, such as newspapers, table-cloths, curtains, etc.
- Do not place any sources of danger on the apparatus (for example: liquid filled objects, lighted candles).
- The use of apparatus is in tropical and/or moderate climates.

2.3 Moisture

- To reduce the risk of fire or electric shock, this apparatus should not be exposed to rain, moisture, dripping or splashing.
- Do not use this apparatus near water.

2.4 Remote Control Battery

The remote control supplied with this unit contains a coin/button cell battery. To prevent battery leakage which may result in bodily injury, property damage, or damage to the unit:

- Install the battery correctly, + and - as marked on the unit.
- Remove the battery when the unit is not used for a long time.
- Do not expose the battery or remote control to excessive heat, including sunshine.
- **CAUTION:** Danger of explosion if battery is incorrectly replaced. Replace only with the same or equivalent type.
- **WARNING - DO NOT INGEST BATTERY - CHEMICAL BURN HAZARD.**
- If the battery is swallowed, it can cause severe internal burns in just 2 hours and can lead to death. Keep new and used batteries away from children. If the battery compartment does not close securely, stop using the product and keep it away from children. If you think batteries might have been swallowed or placed inside any part of the body, seek immediate medical attention

Disposal of Batteries

The battery supplied contains perchlorate material and in many areas batteries may not be disposed of with your household waste. Please ensure you dispose of batteries according to local regulations.

The battery supplied does not contain the heavy metals mercury or cadmium.

2.5 Servicing

Servicing is required when the unit or mains cord has been damaged in any way, liquid has been spilled or objects have fallen into the apparatus, the apparatus has been exposed to rain or moisture, it does not operate normally, or has been dropped.

Refer all servicing to qualified service personnel.

3.0 Symbols used on this product



Class II Equipment Symbol

This symbol indicates that the unit has a Class II double insulation system, and no protective earth provided.



High Voltage Hazard Symbol

This symbol indicates uninsulated material within your unit may cause an electrical shock. For the safety of everyone in your household, please do not remove the product covering.



Hazard Warning Symbol

The 'exclamation mark' calls attention to features for which you should read this manual closely to prevent operation and maintenance problems.
WARNING: To reduce the risk of fire or electric shock, this apparatus should not be exposed to rain or moisture and object filled with liquids, such as vases, should not be placed on this apparatus.
CAUTION: To prevent electric shock, match wide blade of plug to wide slot, fully insert.



Waste Electrical and Electronic Equipment Symbol

This symbol indicates that when the unit is to be discarded, it must be separated from other household-type waste and sent to separate collection facilities for recovery and recycling of electrical and electronic equipment.

Please make sure you are familiar with your local rules on the separate collection of electrical and electronic products.

Introduction

Thank you for purchasing Q Acoustics.

This manual is intended to take you through the setup and installation of the M3. It will help provide a trouble free setup and optimum performance from the product.

Please read the instructions, important safety information and warnings carefully before installation and use, to ensure the safe and satisfactory operation of this product.

We hope you enjoy the Q Acoustics experience.

Package Content

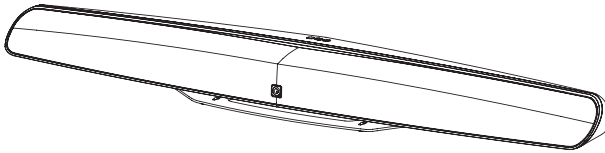

1 x Q M3 Soundbar



1 x Remote Control



1 x lithium Battery
(3V, CR2025)



1 x Mains Cable
(Regional mains cable)



1 x HDMI Cable

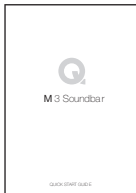

1 x Quick Start Guide

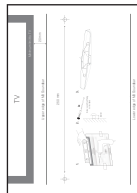

1 x Wall Mounting
Template



1 x Warranty Card

Product description

The M3 is simplicity redefined; where beautifully engineered sound meets beautiful design.

This is an elegantly compact soundbar with a big heart to fill your living room without the clutter of a full Hi-Fi system or even a soundbar with a large external subwoofer.

Q Acoustic's new Intelligent Pre-Amplifier (IPA™) is designed to seamlessly integrate into your home setup. The M3 is a true plug and play soundbar. Connect it to your television using the ARC HDMI input and forget about it. The M3 becomes one with your TV, leaving you to discover both sides of this unique product, Music and Movies.

Turn on the M3 and Music mode is enabled by default. Our built in aptX® Bluetooth® wireless input frees the world of music at your fingertips to fill your home with superbly detailed and dynamic audio reproduction. Discover subtle layers in your music that have been left previously unheard and enjoy music as was intended! Switch on the TV and the M3 automatically brings clarity of speech and a depth of soundscape that transforms your TV sound... and when you engage the MovEQ™ your home will rumble with powerful bass and dynamics for that full blooded movie experience!

Wall-mounted or shelf-mounted the elegant and compact M3 will form an audio centrepiece for your home entertainment.

Wall mount

Important Cautions:

- Q Acoustics accepts no liability for damages caused by incorrect assembly, installation or improper use.
- Ensure that the wall is sufficient strength to hold the weight of the Soundbar and that of the bracket.
- If there is any doubt regarding the condition or the load bearing of the wall, please consult a specialist from the building trade.
- The wall fixings used must be suitable for the type of wall (materials, thickness, condition), so that the maximum load bearing of the wall can be guaranteed.
- Ensure that no electrical cables, water pipes or gas pipes are located within the wall.
- Before mounting, check the location of the nearest mains socket. Use a spirit level when attaching the wall bracket.
- Wear safety goggles when drilling.
- Keep small parts out of reach from children.

1.

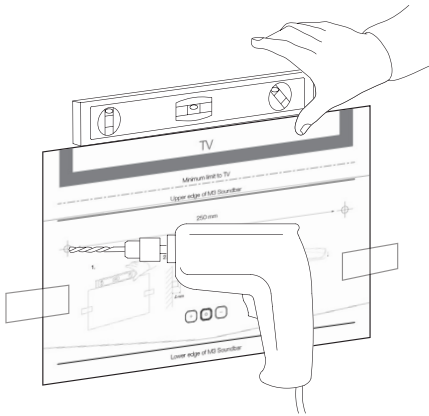

2.

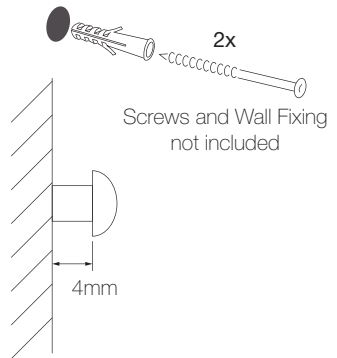

3.

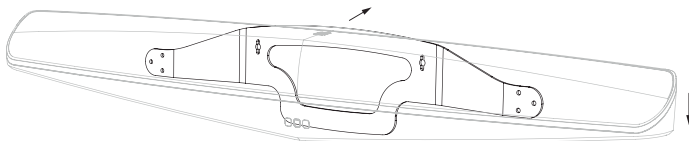

Features

1. Top Panel

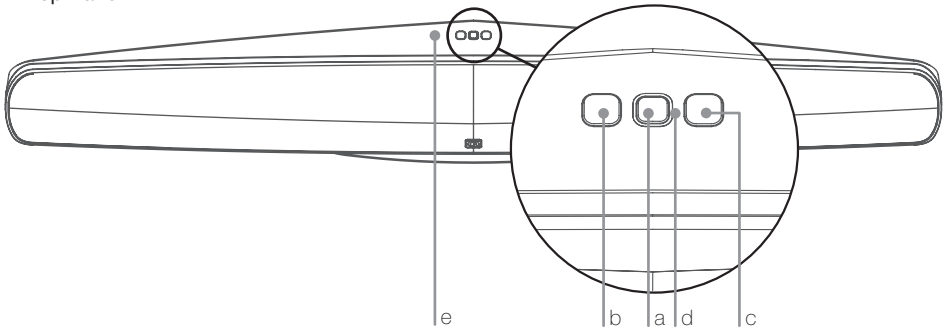

a. Deep standby / Standby / Source select

5s press / 2s press / 1s press

b. Volume Down

Single press / press and hold

c. Volume Up

Single press / press and hold

d. Status LED

See LED indications below

e. NFC Pairing Position

Removable sticker

No Light = Off

Power cord is disconnected.

Dim Red = Off (DEEP STANDBY)

Power cord is connected and the Unit is in DEEP STANDBY.

Solid Red = Off (STANDBY)

Power cord is connected and the Unit is in STANDBY.

Solid Purple = On

HDMI input is the active source.

Solid White = On

Optical input is the active source.

Solid Blue = On

Bluetooth® input is the active source and is Paired with a Bluetooth® device.

Quick Blue Flash = On

Bluetooth® input is the active source and is currently searching for a Bluetooth® device to Pair with.

Solid Green = On

Analogue input (Line in 1 or Line in 2) is the active source.

Yellow = MovieEQ™

MovieEQ™ setting is toggled between On / Off.

Any Colour Slow Flash = On

Currently active source is MUTED.

2. Front

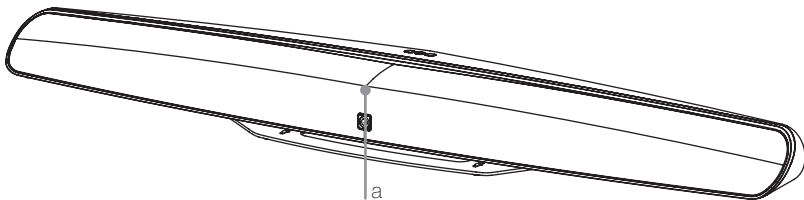

a. IR Sensor

The IR sensor is hidden behind the speaker grille in the centre towards the top of the Unit.

This sensor **MUST** be unobstructed for direct line-of-sight to the remote, or the remote will not be able to control the Unit.

3. Rear Panel

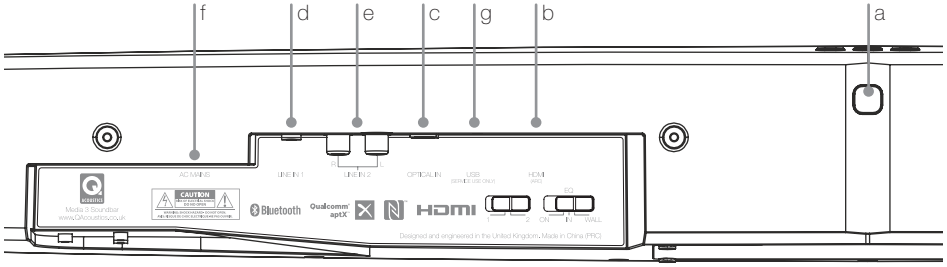

- a. Bluetooth® Pair Button
- b. HDMI™ (ARC) Input
- c. Digital Optical Input
- d. Analogue Line In 1
- e. Analogue Line In 2
- f. AC Mains Input
- g. USB for Service Only

a. Bluetooth® Pair Button

The Bluetooth® Pair button is used to manually drop any current Bluetooth® connection and make the Unit Discoverable by a new device.

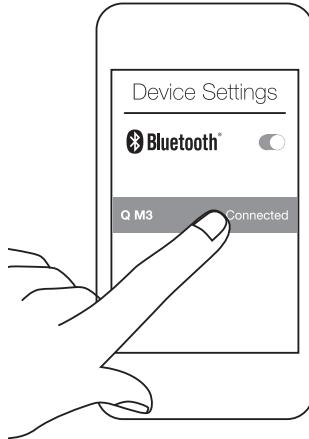

b. HDMI (ARC)

HDMI™ (ARC) is for connection to the Audio Return Channel (ARC) output on a TV or other source. If there is a choice between HDMI™ or Optical connection to the Unit choose HDMI to enable Consumer Electronic Control (CEC). When the HDMI source is active the status LED will be PURPLE.

Important Note: Audio output of a TV, Blu-ray disc player, games console, or DVD player connected to the Unit via HDMI, must be set to PCM (two channel stereo) in the source setup.

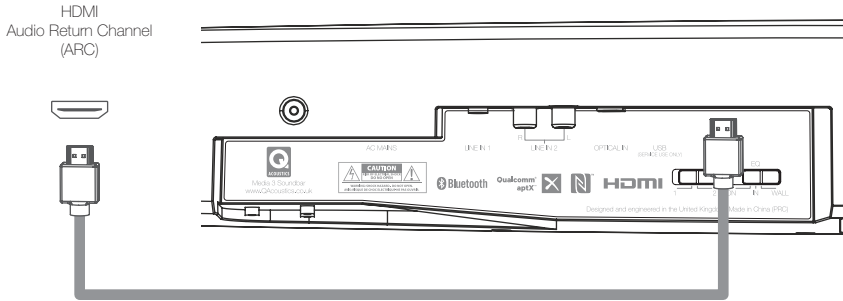

c. Optical Input

Optical In is for connection to the Digital Optical output on a TV or other source. If there is a choice between Digital or Analogue connection to the Unit choose Digital for superior audio quality. When the Digital Source is active the status LED will be WHITE.

Important Note: Audio output of a TV, Blu-ray disc player, games console, or DVD player connected to the Unit via Optical Digital, must be set to PCM (two-channel stereo) in the source's setup. Digital connection to a CD player does not require a special setting.

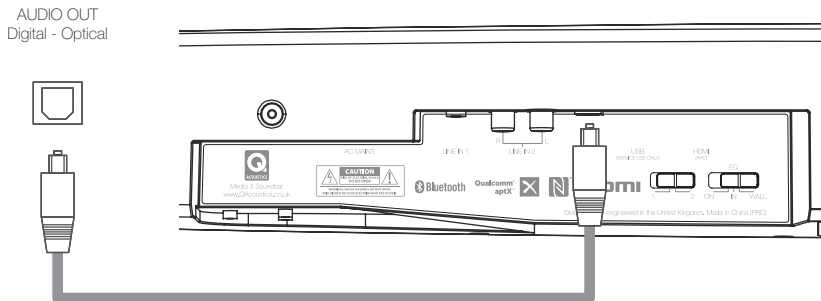

d. Analogue Inputs Line In 1

The Unit has two options for Analogue audio connection. The Status LED will be GREEN when an Analogue input is in use.

AUDIO OUT
Headphones

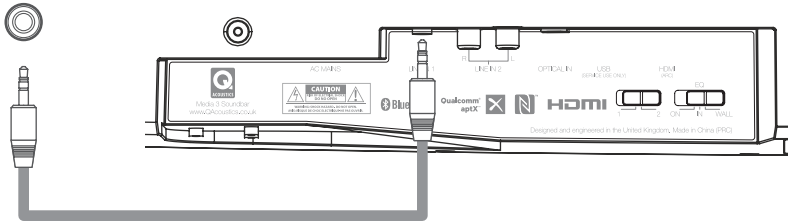

e. Analogue Inputs Line In 2

Connect the RCA L&R audio output from a TV or other source to the LINE IN 2 sockets using a Phono RCA cable.

Important Note: Audio output of a TV, Blu-ray disc player, games console, or DVD player connected to the Unit via HDMI, must be set to PCM (two channel stereo) in the source setup.

AUDIO OUT
Analogue

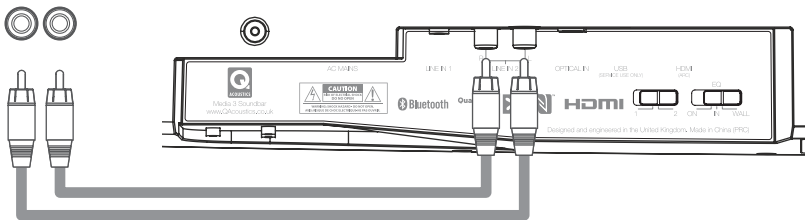

Important Note: With a jayvck plugged into LINE IN 1, LINE IN 2 is switched-off and no audio will be heard from this source.

Please Note: When connecting to a variable level source, such as a headphone output, better audio quality will be achieved by having the source set at a higher volume level and the Unit at a lower level, than the other way around.

f. AC Mains Input

Universal power connector automatically selects AC voltage for a given region. Connect to the included AC Mains Cable for your country.

Important Note: Always remove the AC Mains Cable when making connections to the Rear Panel.

AC MAINS
Regional mains cable

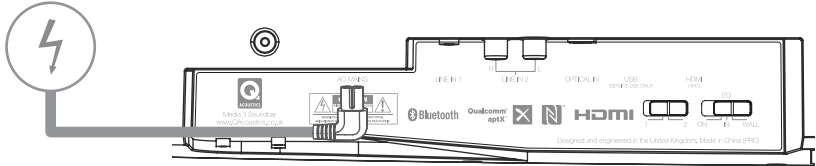

g. USB for Service Only

Universal Serial Bus (USB) for service only. This USB port will not provide 5V power, and cannot be used for anything other than Service Updates.

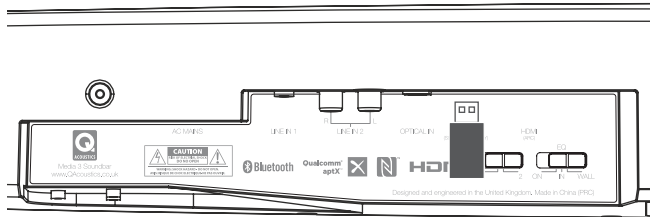

4. Remote control

a. Power

Press this button to turn the Unit STANDBY ON/OFF.

b. Source select

Press this button to manually select the audio input source. The status LED will change colour accordingly.

Important Note: When the Source button is used, the Unit will stay on the selected source and disable the Intelligent Pre-Amplifier (IPA) automatic source selection. IPA functions will be reactivated after the Unit has been put in STANDBY.

c. Volume Up / Down

Press VOL + to increase the volume. Press VOL – to reduce the volume.

d. Mute

Press this button once to MUTE the Unit. Status LED will SLOW FLASH to indicate MUTE. Press this button again to un-mute the Unit.

Please Note: Long press of Mute will also put the Unit into STANDBY.

e. EQ

Short press the EQ button to toggle MovIEQ™ On and Off. If the Yellow LED flashes and remains on, MovIEQ™ is On.

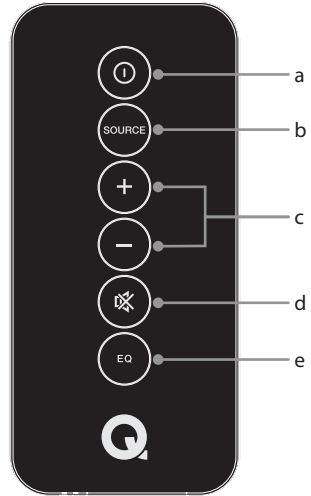

Remote Control battery replacement

Caution: When replacing the lithium battery in the remote, make sure that the replacement battery is inserted with the correct polarity. Place the battery so that the positive (+) side faces up with the tray held so the surface with the dot and (+) is facing up.

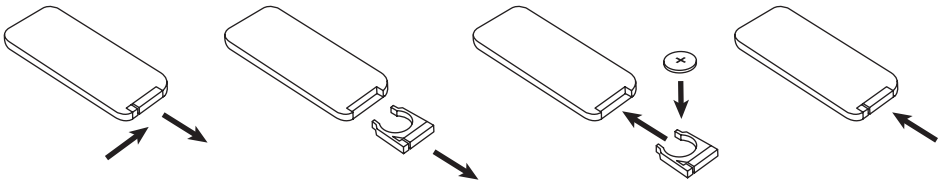

a. Push small tab toward battery slot.

b. Pull battery drawer out.

c. Insert battery with “+” side up and slide drawer back into remote.

d. Slide drawer back into remote.

Caution: Danger of explosion if battery is incorrectly replaced. Replace only with the same or equivalent battery type (CR2025)

Warning: Do not expose batteries to excessive heat such as direct sunlight, fire or the like. Dispose of dead batteries in accordance with local regulations.

Operating Q Acoustics Unit

1. On / In / Wall EQ

This EQ switch should be the first thing you set on your Unit. The Unit has been voiced by our acoustic experts to get the best audio performance possible for the three most common placements within a room.

Simply select the placement that best fits your living environment using the switch on the Rear Panel, and let Q Acoustics handle the rest.

ON = On a cabinet
IN = In a cabinet
WALL = Wall-mounted

2. Power and standby

With the AC Mains turned off, plug in the AC Mains Cable. Once all Rear Panel audio connections are made, turn the AC Mains ON. The speakers will enter STANDBY, and show a RED status LED.

Exit STANDBY by turning a connected source ON, or by pressing the STANDBY button on either the Top Panel or the IR remote. The LED will then change colour according to the AUTO SOURCE SELECT rules.

If NO input signals are detected, the Unit will select the Analogue input and then automatically enter STANDBY after 20 minutes.

3. Intelligent Pre-Amplifier (IPA™)

In normal operation the IPA™ will be active.

Q Acoustics IPA™ is designed so the user requires the minimum amount of effort to get full functionality.

The IPA™ will AUTO ON/OFF and AUTO SOURCE SELECT according to our carefully designed intelligence matrix.

4. Auto On / Off

When connected to an audio source, the Unit has an AUTO ON function and will come out of STANDBY when it detects an active audio signal is connected.

When the audio signal is stopped for a pre-defined period of time, the Unit has an AUTO OFF function and will go into STANDBY.

This, for example, allows easy integration of the Unit with your TV, automatically turning ON and OFF in synchronisation with your TV STANDBY control.

5. Auto On / Off Times

5.1. HDMI™

- ON time is determined by the CEC response time of your TV; it can take between 0-10s.
- OFF time is determined by the CEC response time of your TV; it can take between 0-5s.

5.2. Optical

- ON time is immediate once the red Optical light from your source comes on.
- OFF time is immediate once the red Optical light from your source turns off.

Please Note: *Some televisions continue their optical output when the TV is in STANDBY. The Unit will not AUTO OFF under these circumstances and the STANDBY control must be used.*

5.3. Bluetooth®

- ON time is determined by the AVRCP response time of your Bluetooth® device; once your device is connected, and you press Play it can take between 1-5s.
- OFF time is determined by the AVRCP response time of your Bluetooth® device. Once you turn Bluetooth® off, or disconnect your device it can take between 1-3s.

5.4. Line In 1 / 2

- ON time is determined by the audio signal level; when the signal level is audible it can take between 1-3s.
- OFF time is determined by the audio signal level; when the signal level is not audible it will take 20 minutes.

Please Note: *If the user places the Unit in STANDBY while a source is still playing, the AUTO ON function will be disabled until the source is stopped. This will prevent the Unit from unwanted AUTO ON. For Line In 1/2 the signal must be at a not audible level for 20 minutes before the Unit AUTO ON will function.*

6. Auto source select

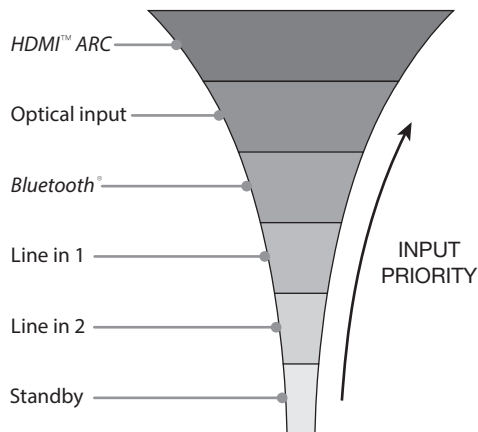

The IPA™ follows a priority list for connected audio sources. A connected HDMI™ source that starts to play has the highest priority, followed by Optical, then Bluetooth® and finally Analogue 1 and 2:

Important Note: *The IPA™ can be overridden at any time by a simple manual SOURCE SELECTION from the user. Simply press the SOURCE SELECT button on the remote, or a short press of the STANDBY Button on the Unit.*

The IPA™ will reactivate once the Unit has been put into STANDBY.

7. Low source gain (LSG™)

During our extensive testing we found that on a number of manufacturer's equipment the digital signal output level is lower than the expected Full Scale (FS). To allow our users to get the best audio experience from the Q Acoustics Unit we have included a LSG™ switch.

The LSG™ switch can be found on the Rear Panel, and has two settings.

1 = Normal gain

2 = Increased 6dB of gain for Optical and HDMI™ sources

You should first listen to your setup with LSG™ = 1

If you find your signal level to be quite low from your TV/DVD player/Music source, please select LSG™ = 2.

Please Note: *You will not require the LSG™ if you are using a Streamer/CD player Optical output. Hi-Fi audio equipment will output FS digital audio. Audio will be highly distorted if you have LSG™ = 2 in this scenario.*

8. Source volume control

Audio sources will initially be set at a DEFAULT volume level. The volume can be adjusted separately for each source using the VOL + and VOL – buttons on the Top Panel or IR remote. Once adjusted, the IPA™ will remember the new volume level for the currently selected source, and will return to that level each time that source is re-selected.

9. Bluetooth®

9.1. Pairing a Bluetooth® device

The Unit is designed to be Discoverable when in STANDBY, to allow AUTO ON. It is also designed to automatically go into Pairing mode if there is no Bluetooth® device connected. To Pair your Bluetooth® source:

1. Connect the AC Mains Cable to the Unit and switch ON.
2. Make sure Bluetooth® is enabled on the device to be Paired. The Bluetooth® controls are typically found in the device's 'Settings' or 'Connections' menu.
3. On your device's list of discoverable devices, you should now see 'Q M3'.
4. Select 'Q M3' and your device will now be Paired via Bluetooth® and Connected.
5. From within the music player on your device, select 'Q M3' as the audio output and press Play. Unless the remote has been used to manually select another source and override the IPA™, or a higher priority source is active, the Unit will switch to Bluetooth® input and the LED will turn Blue.

9.2. Pairing a Bluetooth® device with NFC

1. Connect the AC Mains Cable to the Unit and switch ON.
2. Make sure Bluetooth® and NFC are enabled in the device settings.
3. Place NFC device on the top surface of the Unit, in the location indicated.

Please Note: *You may need to rotate your device for NFC to connect, as NFC coils are in different locations within different devices. Please see your device instruction manual for correct NFC operation.*

The distance needed for successful NFC Pairing can vary from device to device.

4. The NFC device will automatically register on screen when an NFC connection has been made.
5. Follow on-screen instructions to complete NFC Pairing. This usually involves selecting to allow NFC Pairing.
6. Your device will now be Paired, and Connected via Bluetooth®, and will function as any other Bluetooth® source when pressing Play from within the device music player.

Please Note: *Although starting to Play a track on the connected source will cause the Unit to switch to Bluetooth®, the Unit will stay on Bluetooth® until the source is Disconnected. It will not switch to a lower priority source whilst the player is Paused.*

Please Note: *The IPA™ will switch to Bluetooth® the first time a connected device sends any audio signal, including message alerts, notification and key press effects.*

Please Note: *When Connected, the device's volume and mute buttons will control the Unit using AVRCP. You will also notice that if you switch away from the Bluetooth® source, your currently playing track will PAUSE for you.*

Not all Bluetooth® devices are AVRCP compatible.

9.3. Going out of range

When a Connected device goes out of range, the Unit will remain on the Bluetooth® channel. When the device returns in range it will automatically re-connect to the Unit. In many cases Play must be pressed on the device to resume audio playback. Whilst out of range, the Unit source can still be changed using the SOURCE SELECT button or by turning on a higher priority source.

Please Note: *If the Bluetooth® source does not come back into range for 20 minutes the Unit will automatically go into STANDBY.*

9.4. Pairing more than one Bluetooth® device

The Unit can have up to eight Bluetooth® devices in its Pairing list. When you Pair with the 9th device the details of the first device will be lost.

Once the Unit is connected with a device, it will stop automatically searching for other devices to Pair with or Connect to. To Connect to another device, either Disconnect the currently connected source on the device itself or press the Bluetooth® Pair button on the Rear Panel of the Unit.

9.5. Coming out of standby

If there is a Paired device in proximity to the Unit when it comes out of STANDBY it will automatically initiate a connection to the device. It will not switch to Bluetooth® input until Play is pressed on the device.

10. MovieEQ™

MovieEQ™ is Q Acoustics' preferred balance to maximize the excitement and drama from your TV and Movie viewing.

MovieEQ™ is simply toggled On or Off by pressing the Remote Control EQ button. The LED will indicate whether MovieEQ™ is turned on by a flash pattern shown below:

Yellow flash x 2 + On = MovieEQ™ On

Yellow flash x 2 + Off = MovieEQ™ Off

11. Lip Sync

The Unit has a lip sync feature for its HDMI™ and Optical inputs. This allows up to 50ms of delay to be added to the audio for synchronisation with a screen. When in Lip Sync mode, the lip sync is adjustable in 10ms steps using the Vol + and – buttons.

To enter Lip Sync mode simply double tap the Bluetooth® Pair button on the Rear Panel of the Unit.

The lip sync time is then adjusted and displayed by the following flash pattern, the LED will maintain the colour of the currently selected source:

0ms = 2 flash

10ms = 4 flash

20ms = 6 flash

30ms = 8 flash

40ms = 10 flash

50ms = 12 flash

After 30 seconds of no other button presses the Unit will exit Lip Sync mode and return to normal operation. You will only have to set the Lip Sync once as the Unit remembers the delay times for both HDMI™ and Optical separately.

Cable / satellite remote control

The Q Acoustics system has been designed for easy integration into your home entertainment system as it has the ability to be controlled by many types of PROGRAMMABLE REMOTE CONTROL. This may include the remote control for your SATELLITE and CABLE system if it has PUNCH THROUGH capability. Punch through is the common term for being able to program your remote control to send IR codes to both a TV and an AV Preamplifier/Processor. To use punch through you normally select the TV you wish to support first, and then the AV Preamplifier/Processor.

The Unit uses the PHILIPS RC5 protocol for AV Preamplifiers/Processors. Programming your remote with PHILIPS AV codes should allow you to control volume and mute of your Unit. In some cases you may also be able to control STANDBY and SOURCE SELECT with buttons such as ◀◀ ▶▶ ◀ and ▶ .

Manufacturers often offer several PHILIPS code options for their remote controls. We recommend that you work through the PHILIPS code list for your remote and experiment with each one until you find one that works well with the Unit. It is easiest to recognise when one is working by pressing the volume up/down buttons.

We cannot guarantee that the Unit will work with your particular remote as the IR codes it sends are outside our control, however by supporting the commonly used Philips standard we hope to have made it as easy as possible to gain control of your device with the remote control of your choice.

Below we show how two typical programmable remote controls can be set up.

TYPE 1 (SATELLITE)

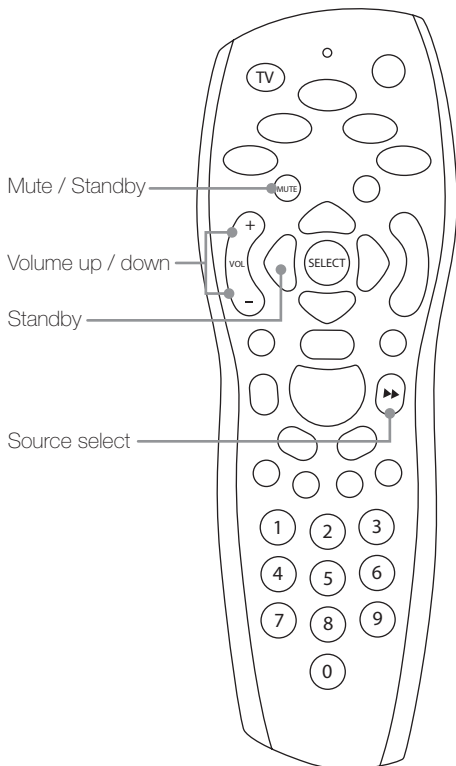

- Press the "TV" button (top left of remote).
- Point remote away from receiver, press and hold "Select + 0".
- The remote's LED will flash red twice.
- Enter "1217". The remote's LED will flash red twice to confirm correct code.
- Press and hold "Select + 1".
- The remote's LED will flash red twice.
- Press TV and your remote controls will now work as below:

Button	Function
Vol +	Volume up
Vol -	Volume down
Mute (short press)	Mute
◀ or Mute (long press)	Standby
▶▶	Source select

TYPE 2 (CABLE)

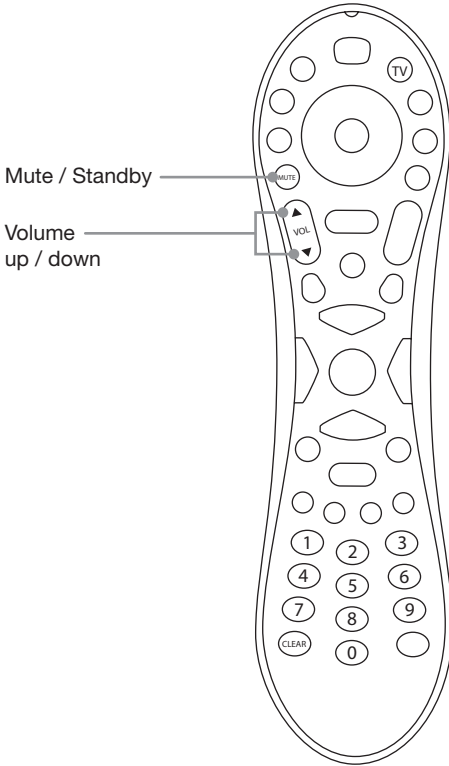

- Press the "TV" button (top right of remote).
- Point remote away from receiver, press and hold "Clear + Vol ▲".
- The remote's LED will flash green twice.
- Enter "1247". The remote's LED will flash green twice to confirm correct code.
- Press TV and your remote controls will now work as below:

Button	Function
Vol ▲	Volume up
Vol ▼	Volume down
Mute (short press)	Mute
Mute (long press)	Standby

Specification

Product	M3
Type	Streamlined Bluetooth® Soundbar
Amplifier	
RMS Output Power	80W (2 x 20W + 40W)
THD (at rated power)	<1.00%
Frequency Response ±0.5dB	20Hz – 20kHz
S/N ratio (A-wtd)	-85dB
Mains Power	100~240V – 50~60Hz – 100W
Acoustics	
Mid-High	BMR 58mm x 58mm
Bass	DVC 100mm x 150mm
Crossover	340Hz
System FQ Response +3/-6 dB	tbc
Power	
Deep Standby	<0.5W
Standby (Network Connected)	<2.0W
Idle	11.0W
Connections	
Optical DAC	1 x 24-bit 48kHz Toslink
Bluetooth	V4.0 Class II
CODEC	aptX, AAC, MP3, SBC
RCA Phono Maximum Sensitivity	2.10Vrms
3.5mm Maximum Sensitivity	1.10Vrms
Weight and Dimensions	
Height	90mm
Width	1000mm
Depth	127mm
Un-boxed Weight	4.0kg
Key Features	
IPA™	✓
MoviEQ™	✓
LSG™	✓
Lip Sync	✓
NFC	✓
HDMI ARC	✓
CEC	✓
Bluetooth®	✓
AptX®	✓
AVRCP	✓
DAC	✓
BMR	✓
DVC	✓
Sub Out	
Dynamic Bass	✓

Warranty

Q Acoustics Media products are warranted free of defects in materials and workmanship for a period of 1 year from the date of purchase. During the warranty period Q Acoustics will, at its option, repair or replace any product found to be faulty after inspection by the company or its appointed distributor or agent.

Misuse and fair wear and tear are not covered by warranty.

Goods for repair should in the first instance be returned to the supplying dealer. If this is not possible contact Q Acoustics or their appointed distributor for your area to determine the correct warranty procedure. If possible the original packaging should be used to return the product as damage sustained during transit to the repair centre is not covered by the warranty. The warranty does not in any way affect your legal rights.

Warranty can be extended to 2 years by registering your product at qacoustics.co.uk/register.

For service information in other countries contact: info@qacoustics.co.uk

Q ACOUSTICS
Armour Home Electronics Ltd.
Stortford Hall Industrial Park
Bishops Stortford, Herts, UK
CM23 5GZ



The Bluetooth® word mark and logo are registered trademarks owned by Bluetooth SIG, Inc. and use of such marks by Armour Home Electronics Limited is under license. Other trademarks and trade names are those of their respective owners.



Qualcomm aptX is a product of Qualcomm Technologies International, Ltd.
Qualcomm is a trademark of Qualcomm Incorporated, registered in the United States and other countries, used with permission. aptX is a trademark of Qualcomm Technologies International, Ltd., registered in the United States and other countries, used with permission.



The term HDMI and HDMI High-Definition Multimedia Interface, and the HDMI Logo are trademarks or registered trademarks of HDMI Licensing LLC in the United States and other countries.



The N-Mark logo is a registered trademarks of the NFC Forum Inc.

Our policy is one of continuous product improvement.
We reserve the right to change the designs and specifications without notice.
This document contains information that is subject to change without notice.



ACOUSTICS

QACOUSTICS.COM